



Rates and Guidelines

The Nolan Center
296 Campbell Dr.
P.O. Box 1050
Wrangell, AK 99929
907-874-3770

Nolan Center Rates and Guidelines

The Nolan Center is a city-owned facility that opened in July 2004. It has a beautiful view of Wrangell's waterfront. Our facility is the perfect setting for your next meeting, convention, or special event. The Civic Center is also converted into a theater during the weekends. The Wrangell Museum, Gift Shop and Visitor Center are also housed within the facility.

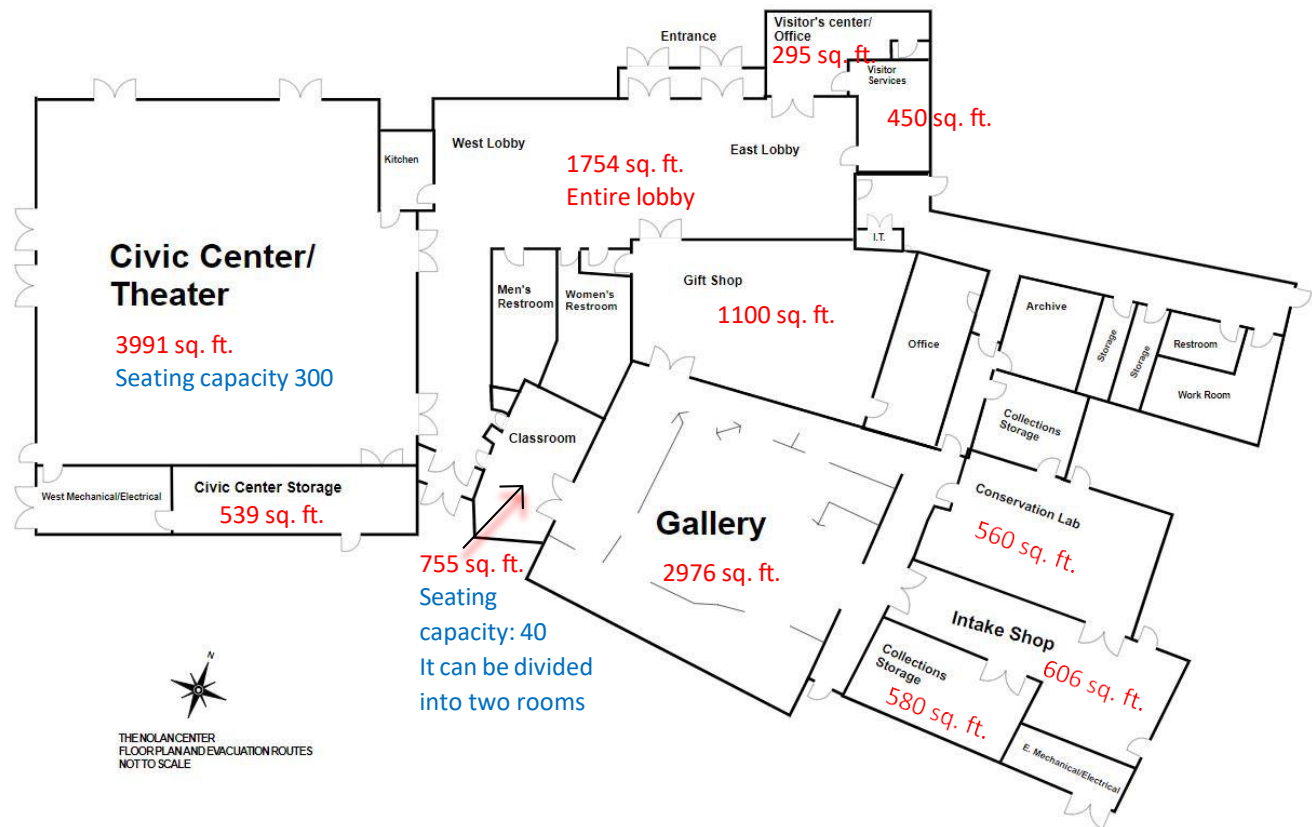

Wrangell Museum Admission Rates:

Alaska Residents	\$8
Out of State Visitors	\$12
Children (under 12)	Free
Organized Group Tours (10 or more)	\$5 Each
School Groups	Free
Friends of the Museum	Free

Regular Room Rental Rates

	1-4 hours	5-8 hours	Over 8 hours
Civic Center	\$600	\$750	\$1200
Half Civic Center	\$400	\$500	\$600
Classroom	\$175	\$200	\$225
Half Classroom	\$100	\$125	\$150
Lobby with another rental	\$75	\$100	\$125
Lobby only	\$175	\$200	\$225
Small Theater	\$125	\$150	\$175
Kitchen	\$100	\$125	\$150
Bar Fee	\$125	\$175	\$225
Beverage Service (coffee, tea, water)	\$75	\$100	\$125
Multimedia (sound system, projector, etc.)	\$50	\$75	\$100
Outside of normal working hours 8-5	\$75 additional fee		

Wrangell Local & Non-Profit Rates

	1-4 hours	5-8 hours	Over 8 hours
Civic Center	\$350	\$450	\$550
Half Civic Center	\$175	\$225	\$275
Classroom	\$150	\$175	\$200
Half Classroom	\$75	\$100	\$125
Lobby with another rental	\$50	\$75	\$100
Lobby only	\$150	\$175	\$200
Small Theater	\$100	\$125	\$150
Kitchen	\$75	\$100	\$125
Bar Fee	\$100	\$150	\$200
Beverage Service (coffee, tea, water)	\$50	\$75	\$100
Multimedia (sound system, projector, etc.)	\$25	\$50	\$75
Outside of normal working hours 8-5	\$50 additional fee		
Birthday Party (during regular movie)	\$75		
Birthday Party (private, older movie)	\$100		
Concessions fee with Birthday Party	\$25		

Additional Fees

Tablecloths	\$7 each	Table skirting	\$10 each table
-------------	----------	----------------	-----------------

Table napkins (cloth)	\$.50 each	Stage with stairs/skirting	\$200
Tables		Quantity	
Round Banquet 60x72 (seats 8 or 9)		25	
Rectangular 6 ft tables 6x30		22	
Rectangular 6 ft tables 6x18 (taller)		27	
Rectangular 8 ft tables (taller)		10	
Cocktail (tall round)		4	
Cocktail (mid-height round)		3	
Stage platforms 4x8		12	

Room rentals include all the tables and chairs, on site staff during your rental, and room clean-up within reason. Excessive clean-up will result in an additional charge of \$30 per hour.

Reservation Request

Please email the Director or Coordinator to request a reservation:

Jeanie, Director : jarnold@wrangell.com

Amber, Coordinator: awade@wrangell.com

Our staff will respond to your request within 48 hours.

You may also call to request a reservation
907-874-3770

Billing

We will invoice you after the event. The online reservation request will give you a price per item specified. Often times items get added or changed during an event, which is why we invoice afterwards.